



# TECHNICAL DATA SHEET : ELECTRONIC BALLAST

Project : STANDARD

Type : ECONOMIC

Model No : HSC-240-118-YCF-OAA

Remark :

## Model : 1 x 18W CFL BALLAST

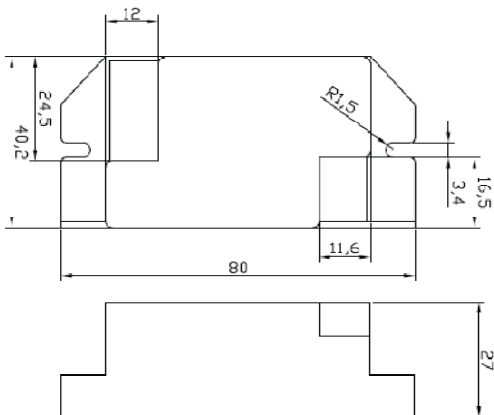

## Input Characteristics

1	Voltage (Un)	240 Vac
2	Operating Voltage Range	140 ~ 277 Vac
3	Frequency (Hz)	50 / 60 Hz
4	Current (A)	0.08 A
5	Wattage (W)	18.5W
6	Power Factor (PF)	> 0.93 (PPFC)
7	Current Harmonics (Athd)	< 35%
8	Over Current Protection	Yes
9	Surge Withstanding Capacity	Yes
10	Over Voltage Application	@ 320Vac 48Hrs & @ 360Vac 2Hrs

## Output Characteristics

1	Lamp Types	18W D/E 2/4 Pin
2	Number of Lamps	1
3	Lamp Connection	Single
4	Lamp Current	0.210A
5	Operating Frequency	≥ 40KHz
6	Ignition Method	RS

## Mechanical Details

1	Weight	45.0 gm
2	Case Dimensions	
	Length W/Mount	80 mm
	Center to Center (CTC)	73 mm
	Width	40.2 mm
	Height	27 mm
3	Case Material	ABS
4	Wiring Diagram	On Screen
5	Input / Output Connections	Connectors, Screw Type
6	Wires Length & Colors	
	Input (White & Black)	N/A
	Output (White)	N/A
	Output (Gray)	N/A
7	Potting	N/A

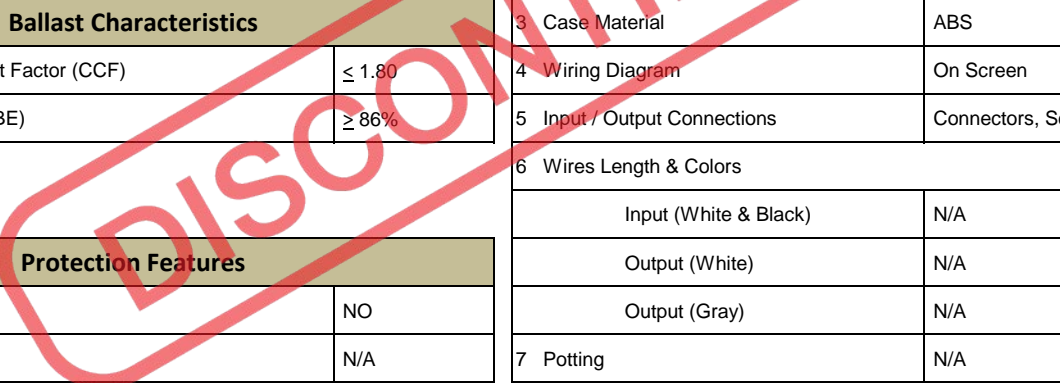

## Ballast Characteristics

1	Lamp Current Crest Factor (CCF)	≤ 1.80
3	Ballast Efficiency (BE)	≥ 86%

## Protection Features

1	Deactivated Lamp	NO
2	Restart or Latching	N/A

## Environmental Operating Details

1	Minimum Lamp Starting Temperature	0°C
2	Max. Ambient Temperature	50°C
3	Max. Case Temperature (Tc)	65°C

## Ordering Information

Sr No	Model Number	Description	Case Lot
1	HSC-240-118-YCF-OAA	1x18W <35% THD CFL D/E 2/4Pin	180

## Notes

A High power factor Electronic ballast specially designed for heavy duty use.

### Key features :-

- Compact Design
- Best replacement for magnetic ballast with lower losses.
- High Voltage withstanding capacity
- High Surge withstanding capacity
- Long Life
- High Durability
- Plastic body (No Earthing Required)
- Economical
- Lamp will not Shut down @ high Voltage

Fulham extends a limited warranty only to the original purchaser or to the first user for a period of 1 years from the date of manufacture when properly installed and operated under normal conditions of use. For complete terms and conditions, please reference the Fulham product catalog ([www.fulham.com](http://www.fulham.com))

Due to a program of continuous improvement, Fulham reserves the right to make modifications or variations in design or construction to the equipment described. © Fulham Company Limited, All Rights Reserved.

DOC NUMBER :- FULTDS002  
REV :-1.2  
Date :-01.04.2013