



T12400400-17F SPECIFICATIONS

IP 20 
SELV Equivalent

- Constant Current LED Driver
- Output Wattage: 17W
- Input Voltage: 240±10%VAC, 50Hz
- Output Current: 400mA ±7%
- Plastic (ABS) Enclosure
- Output voltage range of 21-42VDC
- Suitable for Dry Locations
- SELV Equivalent
- IP 20

General Specifications

| | |
|---------------------------------------|--|
| Rated Input Voltage | 240VAC ±10%, 50 Hz |
| Operating Input Voltage Range | 100-277VAC, 50 Hz |
| Input Current | 0.11 A Max. |
| Input Power | 21W Max. |
| Power Factor | >0.85 |
| THD | <60% |
| Efficiency | >85% |
| Driver Type | Constant Current |
| Output Current | 400mA ±7% |
| Output Voltage Range | 21-42VDC |
| Output Power | 17W |
| Number of Output Channels | 1 Channel |
| Dimming Controller Type/Dimming Range | NA |
| RFI/EMI | NA |
| Output Type | SELV Equivalent |
| Ambient Operating Temperature Range | -10°C to 50°C |
| Max. Case Temperature | 65°C |
| Sound Rating | NA |
| Input Surge Protection | Line-Neutral 3kV DM |
| Protections | Input Over Current : NON-Resettable |
| | Input Over Voltage : 320VAC Operation for 48Hrs, 360VAC Operation for 2Hrs |
| | Input Under Voltage : NA |
| | Output Short Circuit : Auto Recovery (HICCUP Mode) |
| | Output Open Circuit : Auto Recovery (HICCUP Mode) |
| | Output to Ground short : YES |
| | Output Overload : YES |
| | Over Temperature : NA |
| Service Life | 50,000 hours @ Tc Max |
| Approvals / Class | Suitable for Dry Locations |
| Warranty | 3 Years |
| Weight | 0.08 Kg |

Note : All Performance Specified at Rated Voltage and Full Load. Output Current Tolerance : ±7%
Recommended to be used only for Indoor Application.

Figure 1

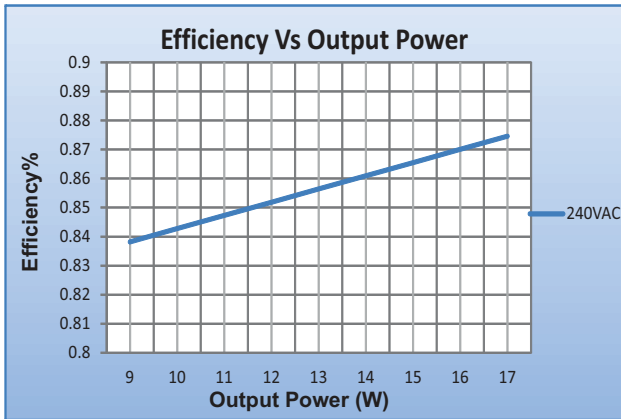

Figure 2

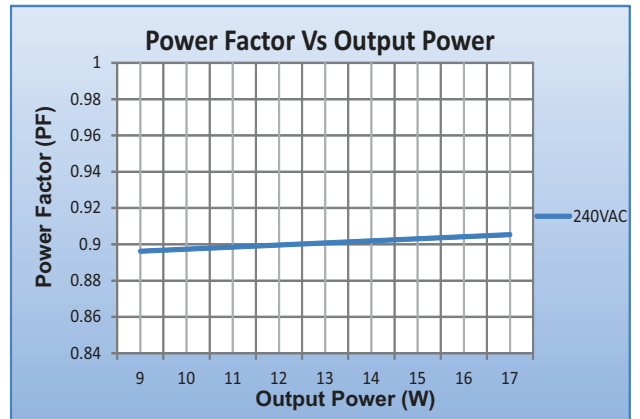

Figure 3

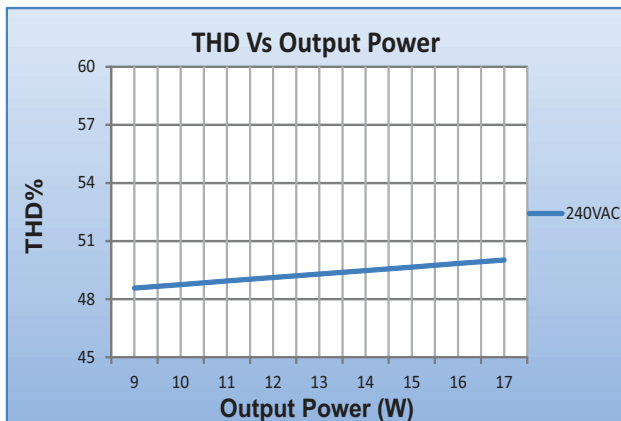

Figure 4

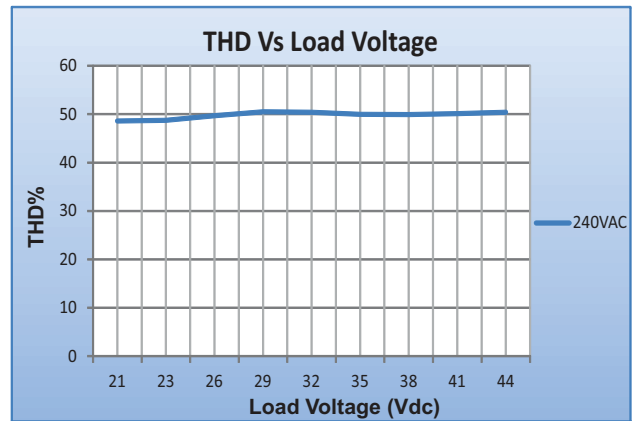

Figure 5

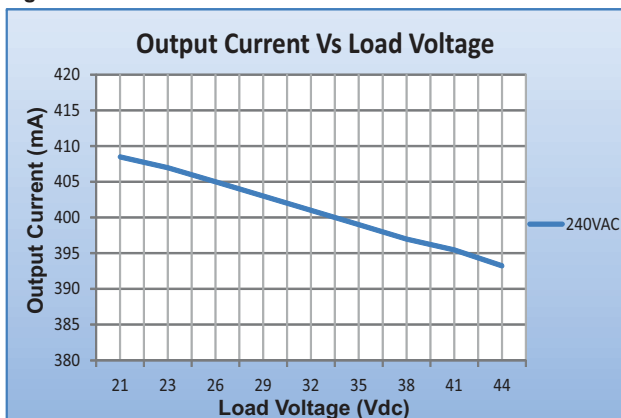
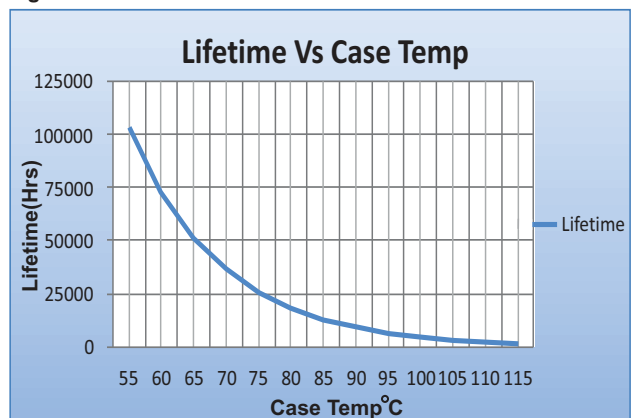
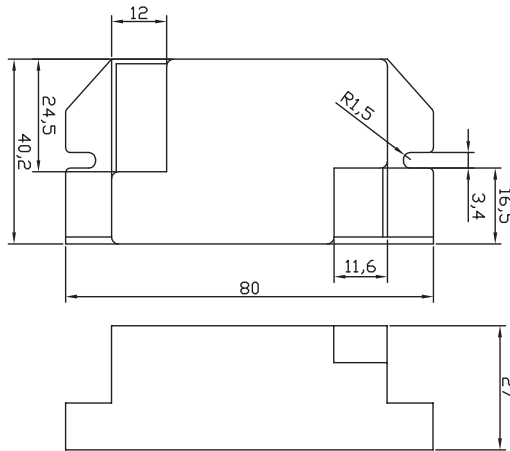

Figure 6



Fulham extends a limited warranty only to the original purchaser or to the first user for a period of 3 years @ Tc 65°C from the date of manufacture when properly installed and operated under normal conditions of use. For complete terms and conditions, please reference the Fulham Product Catalog (www.fulham.com). Due to a program of continuous improvement, Fulham reserves the right to make modifications or variations in design or construction to the equipment described. © Fulham Company Limited, All Rights Reserved.

Mechanical Data



Product Image



Note : All Dimensions are in mm.

Tolerance=±0.5mm

Wiring Diagrams

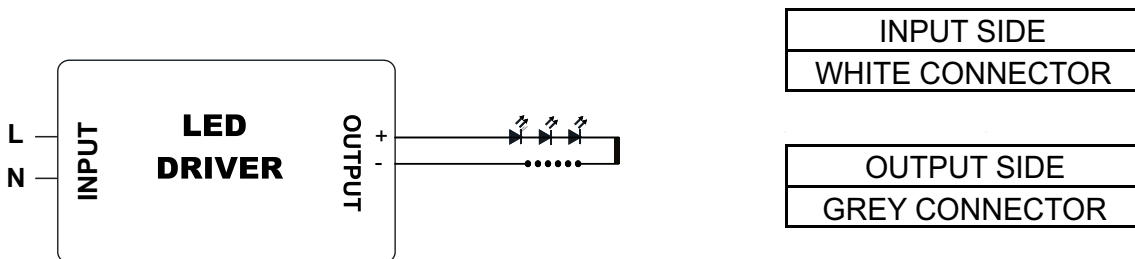

Fulham extends a limited warranty only to the original purchaser or to the first user for a period of 3 years @ Tc 65°C from the date of manufacture when properly installed and operated under normal conditions of use. For complete terms and conditions, please reference the Fulham Product Catalog (www.fulham.com). Due to a program of continuous improvement, Fulham reserves the right to make modifications or variations in design or construction to the equipment described. © Fulham Company Limited, All Rights Reserved.